

order number	lens name
0701-349-000-40	Apo-Rodagon-N 2.8/50

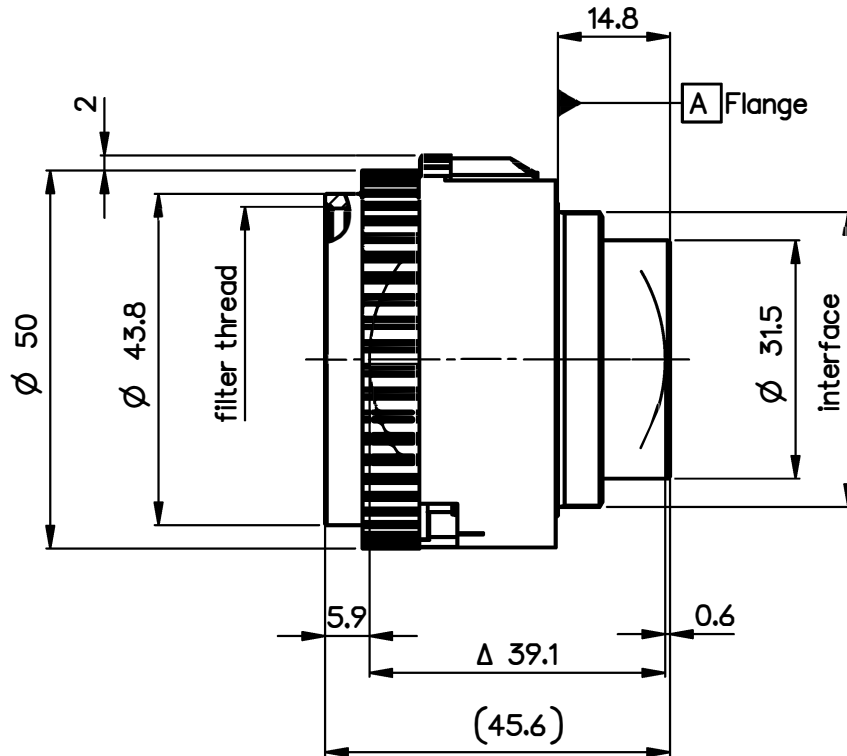

<b>Specification</b>	<b>ON</b>	<b>7509-9021</b>	
image circle max. (mm)	44	working distance (mm)	122 - 1025
focal length f' (mm) *	50.2	interface	M39 x1/26" (Leica)
magnification β' [range]	-0.1 [-0.5 ... -0.05]	filter thread	M40.5 x0.5
spectral range λ (nm)	400 - 750	weight (g)	125

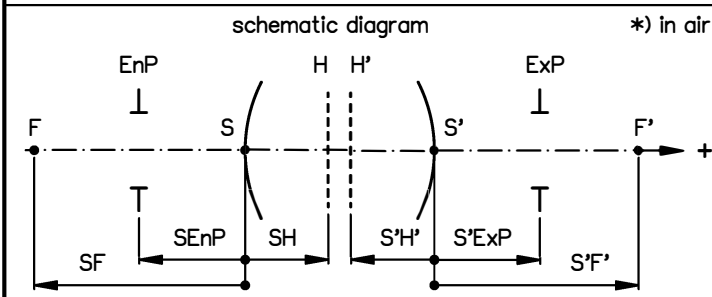

design includes CCD cover glass:		no					
SF (mm)	-27.2	f-stop	2.8	∅ EnP	17.1	∅ Exp	18.0
S'F' (mm) *	31.8						
HH' (mm) *	-2.3						
SH (mm)	23.0						
S'H' (mm) *	-18.4						
SEnP (mm)	20.6						
S'Exp (mm) *	-21.0						

<b>NX</b> PROTECTIVE NOTE "DIN ISO 16016" TO BE OBSERVED	EU-D	AL-T1A	US-D	US-ML	not export controlled	
	REV	ECC	DATE	APPROVED	PDM Status	Freigabe
	b	Neue Urz.			SCALE	1:1
	c	+AP+EP	08.05.98		MATERIAL	
	d	08-2 81	30.09.08		TITLE	Apo-Rodagon-N 2.8/50
e	14-0 184	18.08.14		FIRST	DATE	NAME
				ISSUE	26.05.08	
				CHKD	26.05.08	
				BASIC TOLERANCING PRINCIPLE		
				ISO 8015		
				DRAWING NO.		
				0701-349-100-40-0001e		
				REPLACES		
				SHEET		1
				OF		1

ALL DIMENSIONS ARE IN MM AND INCLUDE SURFACE TREATMENT

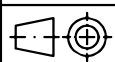

DRAWING NO. 0701-349-100-40-0001e

SHEET 1 OF 1

# Apo-Rodagon-N 2.8/50

**Modulation transfer function    Mag. 0.1x    f-stop 2.8**

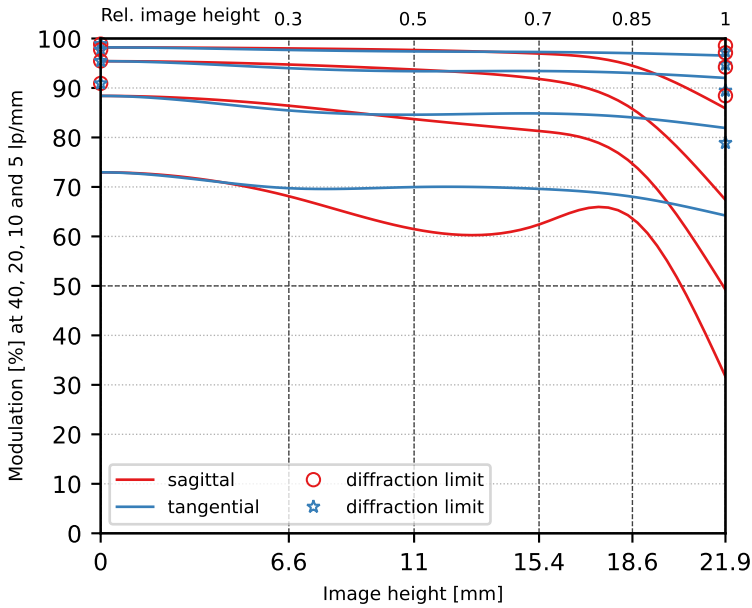

**Fall-off in illumination    Mag. 0.1x**

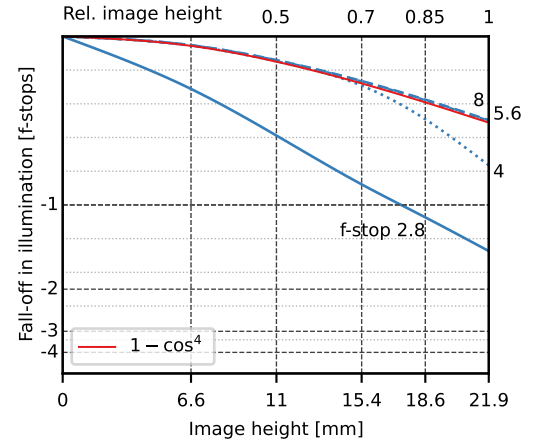

**Modulation transfer function    Mag. 0.1x    f-stop 5.6**

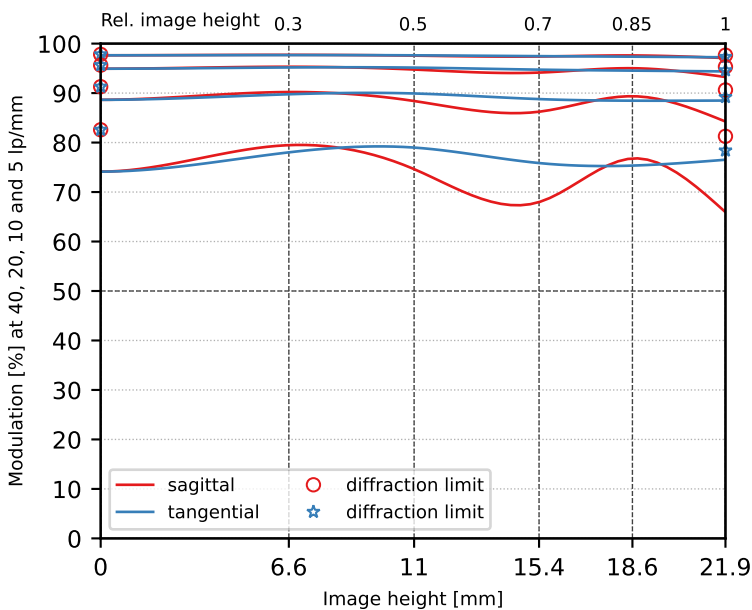

**Distortion    Mag. 0.05x ... 0.5x**

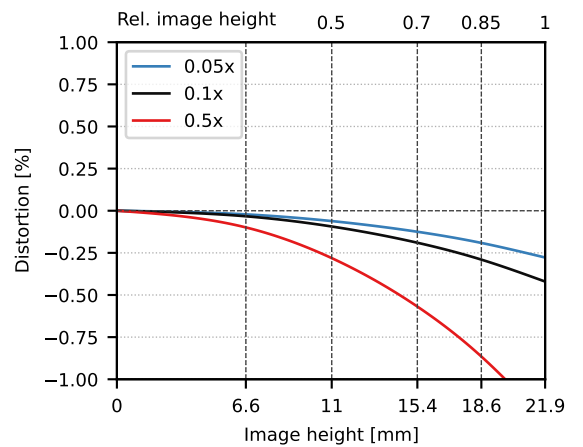

**Long. chrom. aberration    Mag. 0.1x**

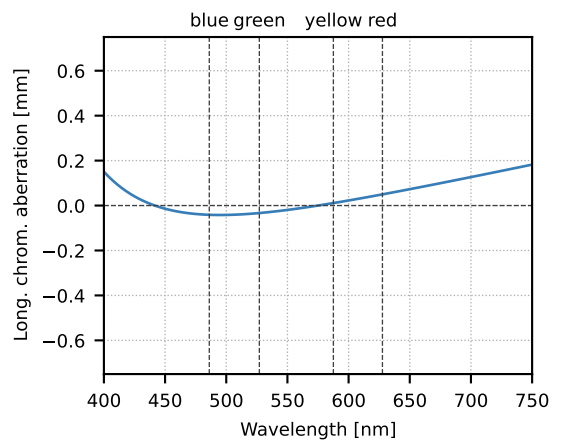

All spatial frequencies [lp/mm], image heights [mm] and magnifications are related to sensor side.