

order number	lens name	azimuth
0703-101-000-40	Apo-Rodagon-D 2x 4.0/75	-

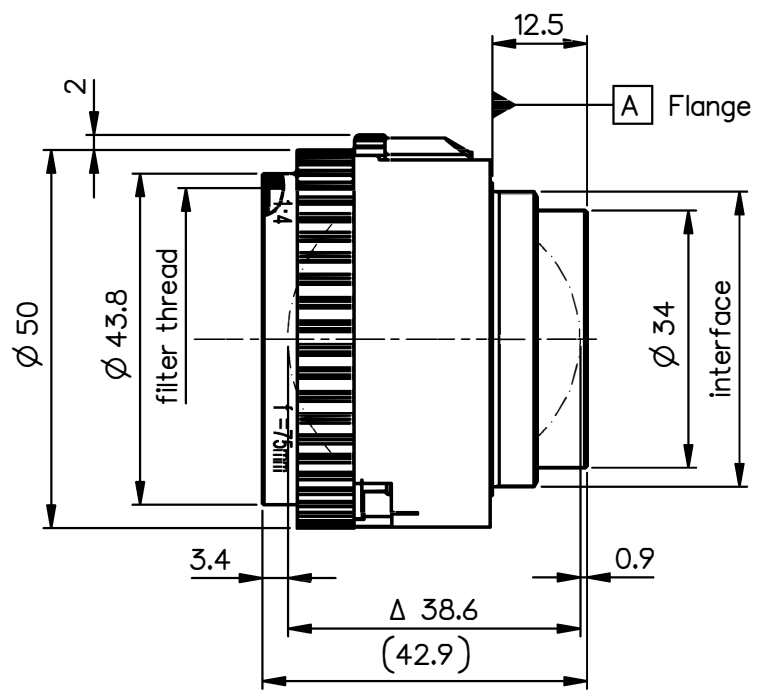

Specification		ON	7604-9341
image circle max. (mm)	86.2	working distance (mm)	138 - 232
focal length f' (mm)	74.7	interface	M39 x1/26" (Leica)
magnification β' [range]	-0.5 [-0.8 ... -0.4]	filter thread	M40.5 x0.5
spectral range λ (nm)	400 - 750	weight (g)	120

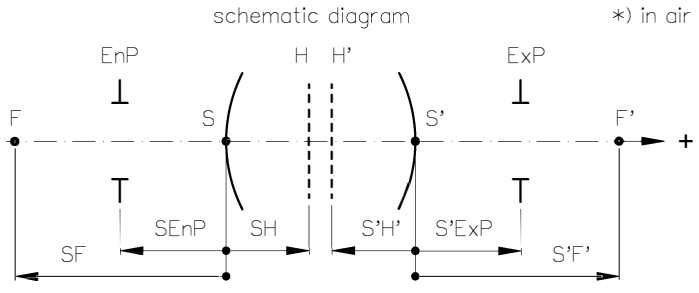

design includes CCD cover glass:		no		
SF (mm)	-48.0	f-stop	Ø EnP	Ø ExP
S'F' (mm) *	60.7	4.0	18.3	19.4
HH' (mm) *	-2.1	5.6	13.1	13.9
SH (mm)	26.7	8	9.2	9.7
S'H' (mm) *	-14.0	11	6.7	7.1
SEnP (mm)	22.4	16	4.6	4.9
S'ExP (mm) *	-18.6	22	3.3	3.5

NX PROTECTIVE NOTE "DIN ISO 16016" TO BE OBSERVED	EU-D		AL-T1A		US-D		US-ML		not export controlled		
	REV	ECC	DATE	APPROVED	GENERAL TOLERANCE OF DIMENSION, FORM, POS.		SURF. TREATMT		PDM Status Freigabe		
	a	Neuausg	01.10.18						SCALE 1:1		
	BASIC TOLERANCING PRINCIPLE								TITLE Apo-Rodagon-D 2x 4.0/75		
DIN A 4		ALL DIMENSIONS ARE IN MM AND INCLUDE SURFACE TREATMENT				FIRST ISSUE		DATE		NAME	
						01.10.18		04.10.18			
								DRAWING NO.		SHEET 1	
								0703-101-100-00-0001a		OF 1	
								REPLACES 0703-028-100-00			

Apo-Rodagon-D 4.0/75 2x

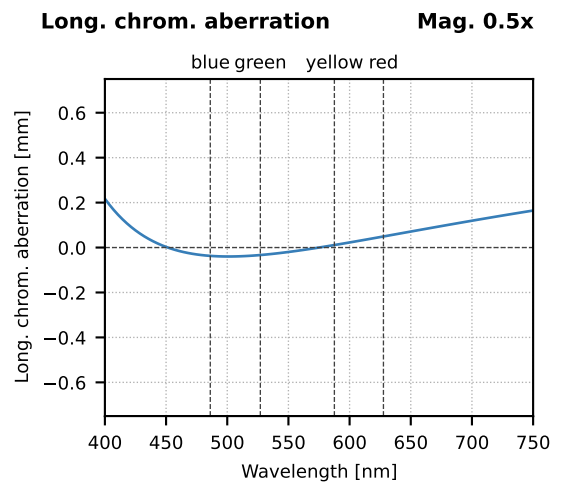
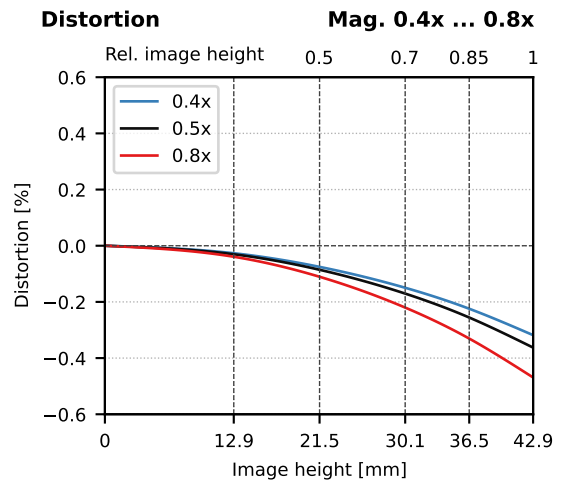
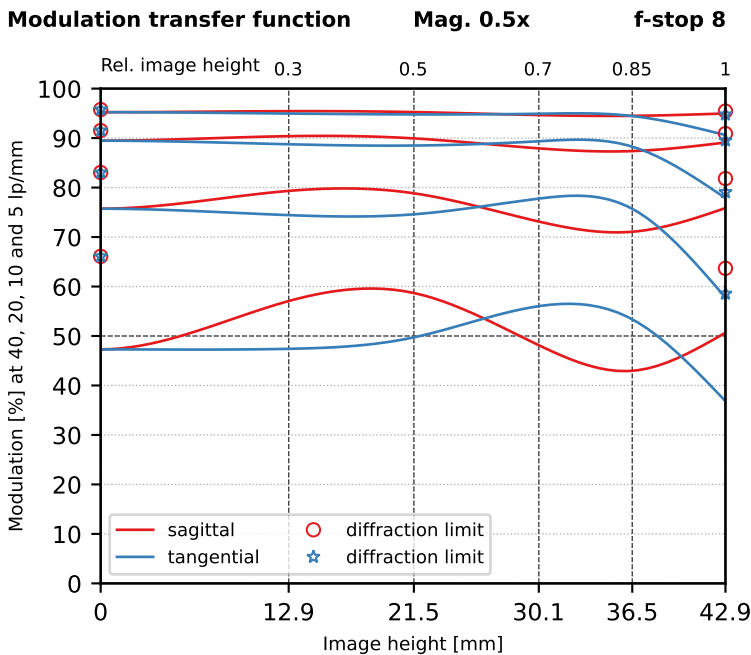
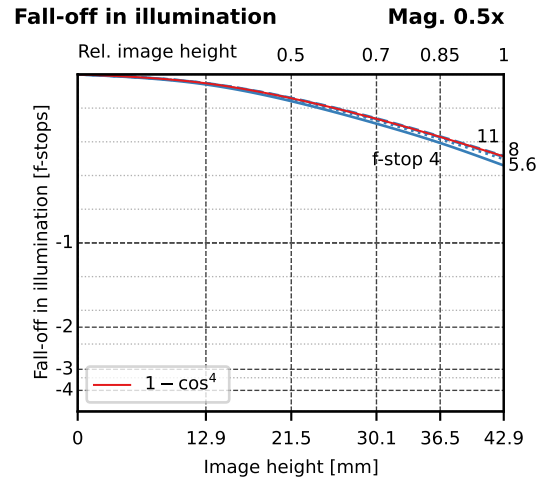
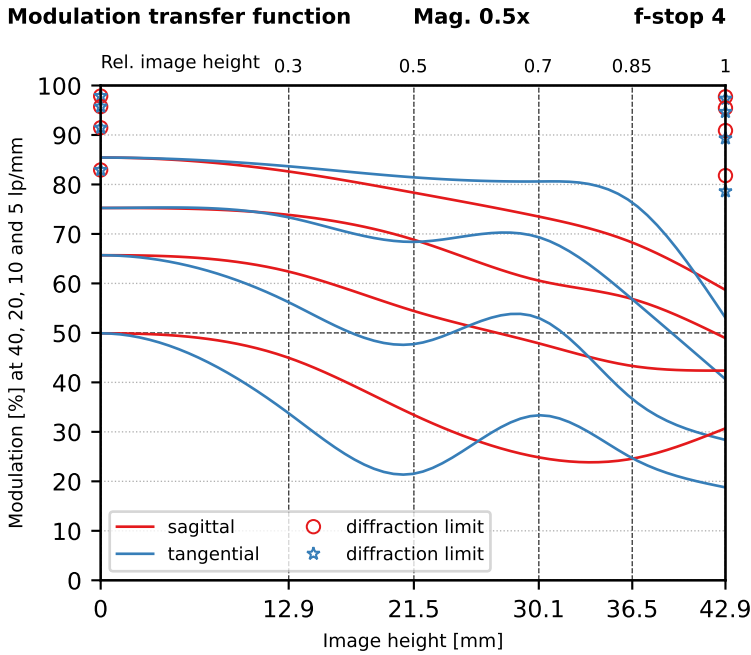

All spatial frequencies [lp/mm], image heights [mm] and magnifications are related to sensor side.