

order number	lens name
0703-043-000-20	Apo Rodagon-D 5.6/120

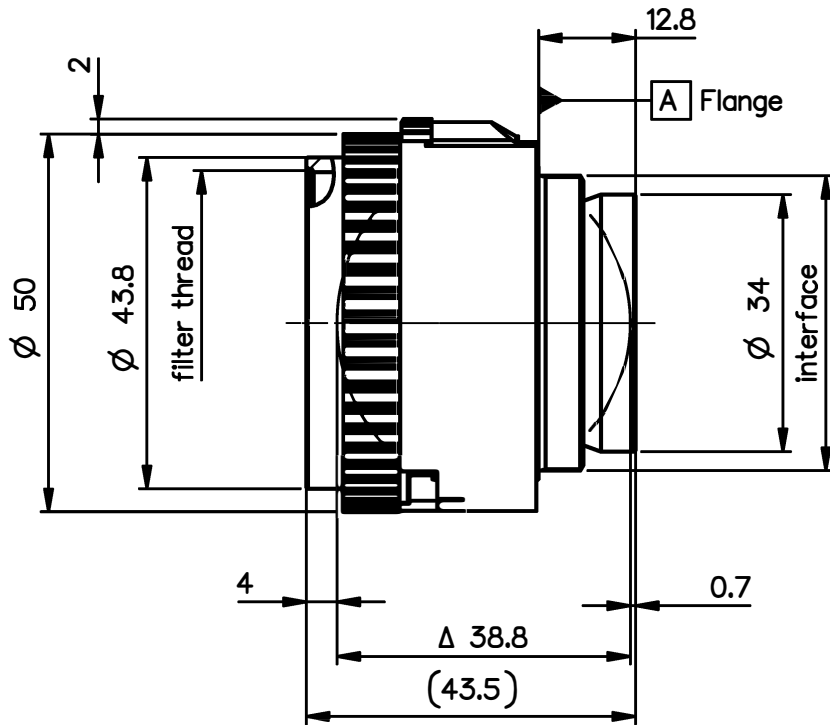

Specification		ON	7514-9022		
image circle max. (mm)	102	working distance (mm)	242 - 456		
focal length f' (mm) *	119.9	interface	M39 x1/26" (Leica)		
magnification β' [range]	-0.5 [-0.8 ... -0.33]	filter thread	M40.5 x0.5		
spectral range λ (nm)	400 - 750	weight (g)	110		
schematic diagram		design includes CCD cover glass: no			
		SF (mm)	-97.2	f-stop	5.6
		S'F' (mm) *	100.9	∅ EnP	20.7
		HH' (mm) *	-3.0	∅ Exp	20.7
		SH (mm)	22.7		15.0
		S'H' (mm) *	-19.0		15.0
		SEnP (mm)	22.8		10.9
		S'Exp (mm) *	-18.9		10.9

NX PROTECTIVE NOTE "DIN ISO 16016" TO BE OBSERVED	EU-D	AL-T1A	US-D	US-ML	not export controlled
	REV	ECC	DATE	APPROVED	PDM Status Freigabe
	a	Neuausg			-
	b	08-281	27.08.08		
	c	11-358	18.07.11		
	d	12-0013	31.01.12		
	e	12-0185	27.03.12		
f	14-0184	14.08.14			
GENERAL TOLERANCE OF DIMENSION, FORM, POS.				SCALE -	
BASIC TOLERANCING PRINCIPLE				MATERIAL	
TITLE				Apo Rodagon-D 5.6/120	
FIRST ISSUE				DRAWING NO.	
DATE				0703-043-100-00-0001f	
NAME				SHEET 1	
CHKD				OF 1	
				REPLACES	
ALL DIMENSIONS ARE IN MM AND INCLUDE SURFACE TREATMENT					

Apo-Rodagon-D 5.6/120 2x

Modulation transfer function Mag. 0.5x f-stop 5.6

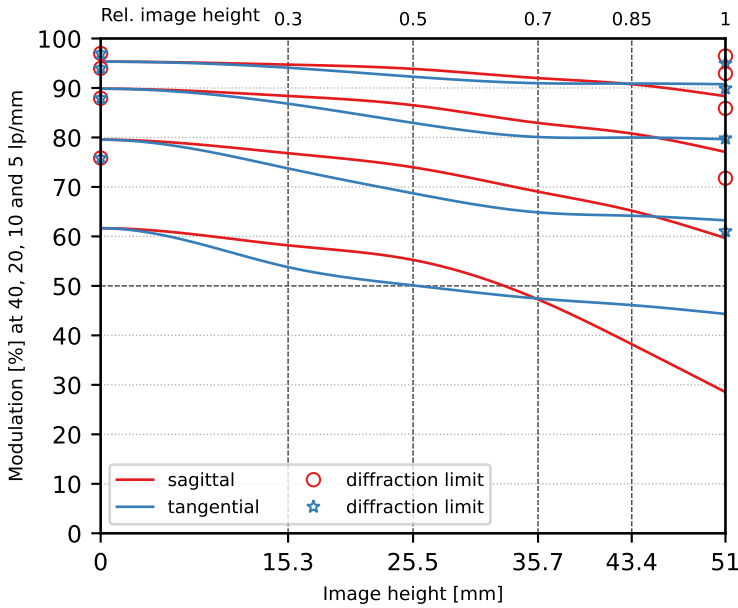

Fall-off in illumination Mag. 0.5x

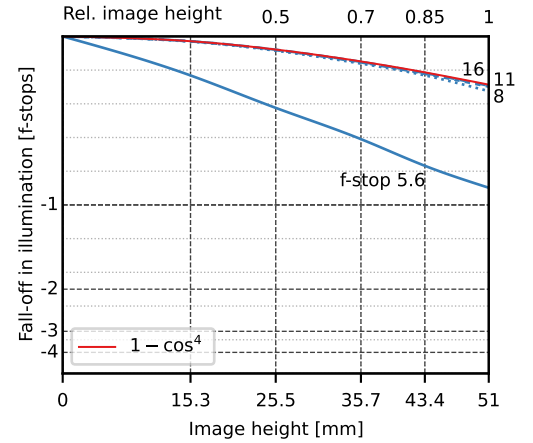

Modulation transfer function Mag. 0.5x f-stop 11

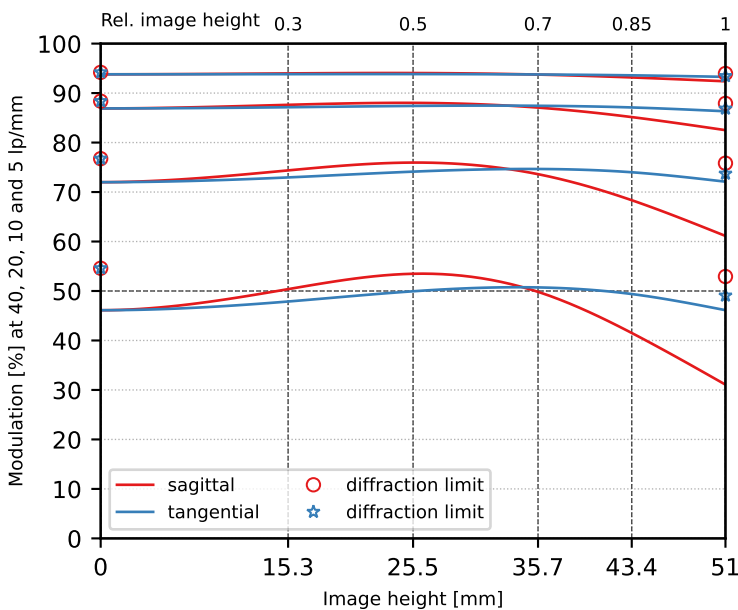

Distortion Mag. 0.33x ... 0.8x

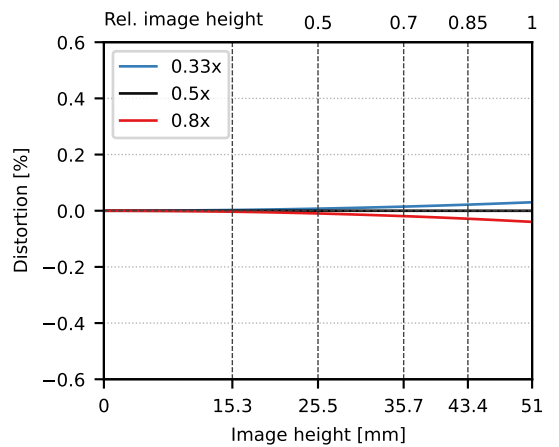

Long. chrom. aberration Mag. 0.5x

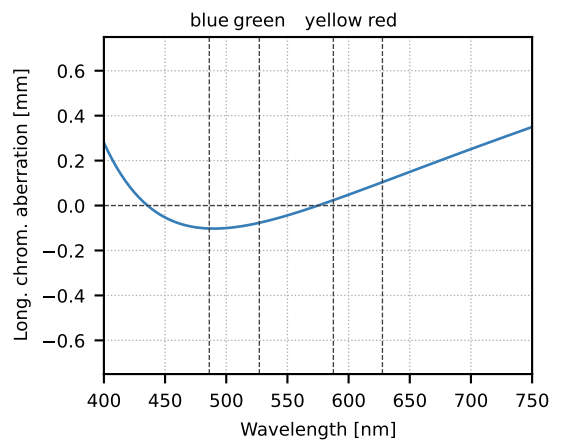

All spatial frequencies [lp/mm], image heights [mm] and magnifications are related to sensor side.